

MEETINGS & EVENTS



SURF & SAND
LAGUNA BEACH

HARD WORK & RELAXATION



Surf & Sand Resort offers a perfect balance of working & relaxing for your meeting or event with spaces that evoke creativity & productivity alongside the resort's peaceful ambiance & sounds of the Pacific Ocean.

Our Laguna Beach resort boasts 10,000 sq. ft. of unique meeting & special event space. Oceanfront terraces make the ideal setting for social gatherings, flexible spaces create intimate environments for group meetings. Additional outdoor spaces are great for welcome cocktails with sunset views or breaks on the sand.



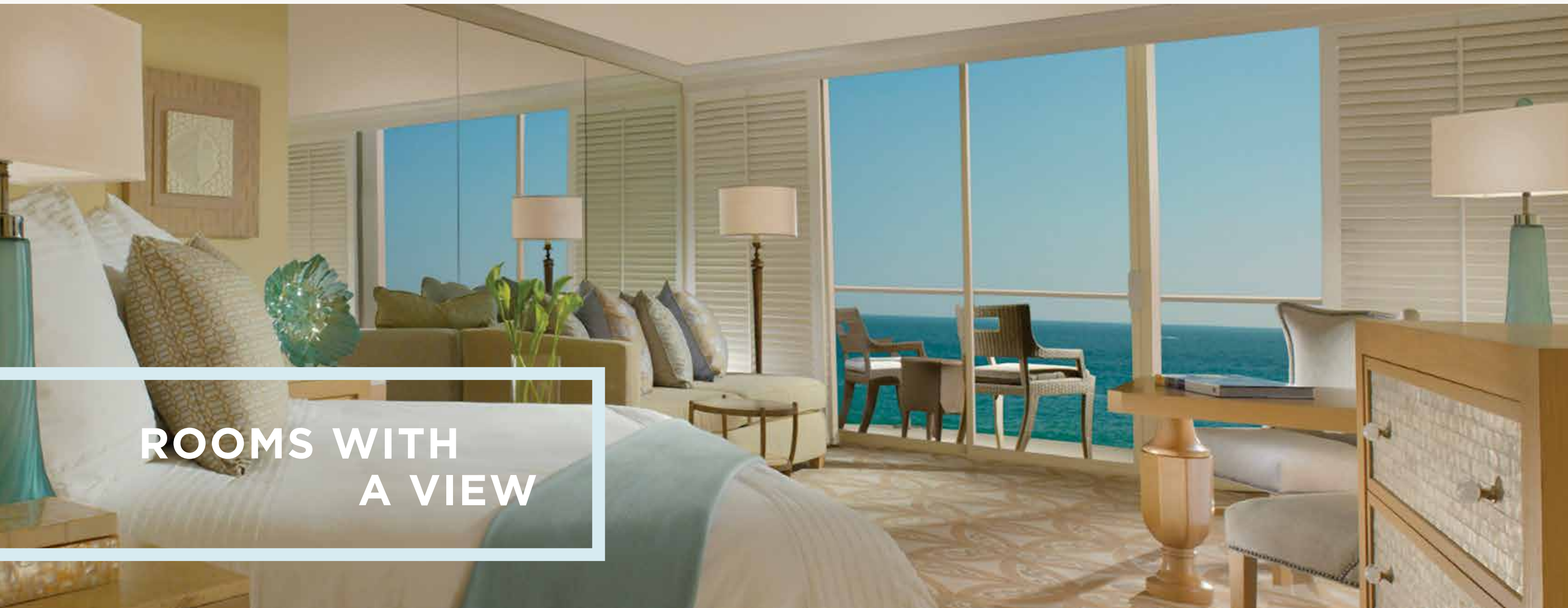

ROOMS WITH A VIEW

Perched directly above the sea, our newly renovated 152 guest rooms and 13 suites feature breathtaking views of the Pacific Ocean & a private balcony so you can watch the waves, the sunset or simply relax.

You will find your guest room has everything you need (big & small) to settle in & feel right at home. Plus, our resort services add a little something extra.

AMENITIES:

- down comforters
- goose-down or non-allergenic foam pillows
- waffle weave cotton robes
- iPod-ready stereos
- high-speed wireless Internet
- well stocked mini-bars
- marble baths with steeping tubs

RESORT SERVICES:

- meetings concierge
- evening turn-down
- room service
- valet

SPACIOUS SUITES



If you need a bit more room, we have thirteen suites, including three penthouses for true VIP living. With spacious parlors & an expansive terrace, they're the perfect spot to lounge, entertain, dine or host a small event.



SUITE LAYOUTS



CALIFORNIA SUITE AMENITIES:

full ocean view
3 rooms
2 full baths, 2 tubs, 2 showers
whirlpool bath
iHome

3 flat screen tvs
cordless telephone
1 sofa sleeper
king size bed
2 armoires

mini-bar
fireplace
hardwood flooring
wood beam ceiling
carpeted bedroom

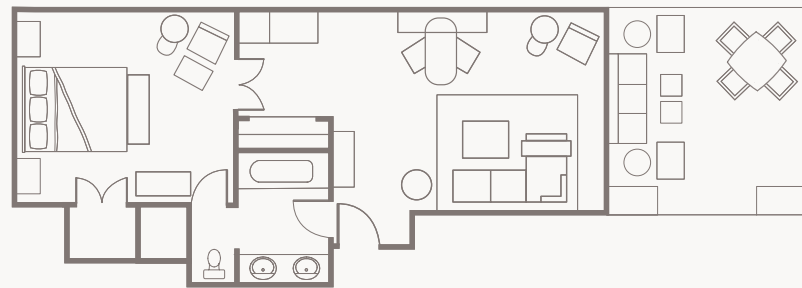

VISTA SUITE AMENITIES:

full ocean view
king bedroom
whirlpool bath
wet bar

spacious parlor area with
pull out sofa sleeper
iHome
cordless telephone

private sundeck with
a panoramic ocean view
flat screen tvs

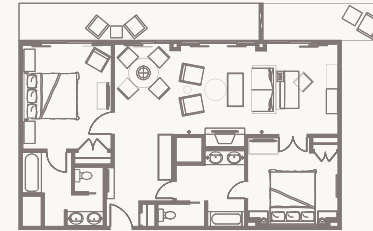

TWO BEDROOM PENTHOUSE SUITE AMENITIES:

1150 sq. ft.
full ocean view
1 king bedroom
1 queen bedroom
2 whirlpool baths
fireplace

cordless telephone
spacious seating area
sofa bed
private balcony
flat screen tvs
iHome

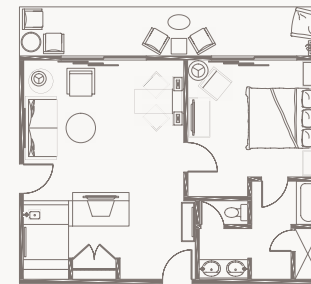

ONE BEDROOM PENTHOUSE SUITE AMENITIES:

700 sq. ft.
full ocean view
king bedroom
whirlpool bath
fireplace
deluxe wet bar

cordless telephone
spacious seating area
sofa bed
private balcony
iHome
flat screen tv

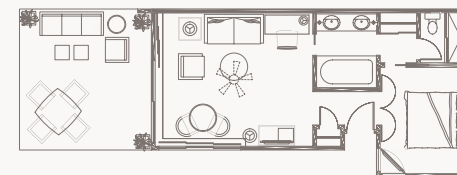

UPPER CATALINA AMENITIES:

600 sq. ft.
full ocean view
king bedroom
whirlpool bath
iHome

cordless telephone
private sundeck
parlor area with sofa bed
flat screen tv

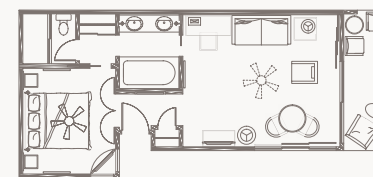

JUNIOR SUITE AMENITIES:

600 sq. ft.
partial ocean view
king bedroom
parlor area with sofa bed
private patio

whirlpool bath
iHome
cordless telephone
flat screen tv



GATHER
& ACCOMPLISH



Surf & Sand offers 10,000 sq. ft. of indoor space & an additional 10,000 sq. ft. of outdoor meeting & event space.

All of our meeting rooms offer

- natural light
- vaulted ceilings
- high-speed internet
- conference service professionals so you can focus on the task at hand

We offer a variety of venues to meet every need, including a stand alone conference center boasting an elevated garden terrace, our Pelican Ballroom & numerous board rooms.

OUR SPACES



PELICAN BALLROOM

The centerpiece of our Conference Center, this spacious room is attached to a terrace.

SANDPIPER

An intimate setting for smaller events, its plantation shutters open onto an outdoor patio.

SAND DOLLAR

Our Conference Center's second-largest indoor venue, it is easily reached from the guest rooms.

SANDCASTLE

With a full wall of windows complemented by mirrored wall accents, this is one of our brightest meeting spaces.

STARFISH

The light & airy room overlooks the aquaterrasp courtyard.

TOP OF THE SURF

A very flexible space able to accommodate a wide range of functions with sweeping views of the beach, great for social events.

SEAGULL, DOLPHIN & GRAY WHALE

Each of these rooms features a wall of windows to let in plenty of natural light.

SEAHORSE

An ideal venue for small meetings & retreats featuring custom-made hardwood table & executive chairs.

MEETING ROOM LAYOUTS

INDOOR VENUES

| ROOM | DIMENSIONS | SQ. FT. | CEILING HEIGHT | THEATER | CLASSROOM | BANQUET | CONFERENCE | U-SHAPE |
|-----------------|------------|---------|----------------|---------|-----------|---------|------------|---------|
| Pelican | 50' x 50' | 2,500 | 9' - 11' | 250 | 160 | 180 | - | 50 |
| Sandpiper | 46' x 20' | 920 | 9' - 11' | 100 | 48 | 70 | 36 | 36 |
| Sandpiper I | 23' x 20' | 460 | 9' - 11' | 40 | 24 | 30 | 20 | 16 |
| Sandpiper II | 23' x 20' | 460 | 9' - 11' | 40 | 24 | 30 | 20 | 16 |
| Sand Dollar | 58' x 21' | 1,218 | 8' - 10' | 120 | 70 | 90 | 40 | 36 |
| Sand Dollar I | 26' x 21' | 546 | 8' - 10' | 50 | 28 | 40 | 20 | 16 |
| Sand Dollar II | 32' x 21' | 672 | 8' - 10' | 70 | 35 | 50 | 32 | 20 |
| Sand Castle | 21' x 49' | 1,029 | 8' | 100 | 60 | 70 | 32 | 32 |
| Starfish | 20' x 34' | 680 | 8' | 60 | 30 | 40 | 24 | 22 |
| Top of the Surf | 30' x 34' | 1,020 | 8' - 9' | 110 | 46 | 70 | 36 | 30 |
| Seagull | 15' x 32' | 480 | 8' | 50 | 24 | 30 | 20 | 12 |
| Seahorse | 15' x 32' | 480 | 8' | - | - | - | 16 | - |
| Dolphin | 15' x 32' | 480 | 8' | 50 | 24 | 30 | 20 | 12 |
| Gray Whale | 15' x 32' | 480 | 8' | 50 | 24 | 30 | 20 | 12 |

OUTDOOR VENUES

| ROOM | DIMENSIONS | SQUARE FEET | CAPACITY |
|---------------------------------|------------|-------------|----------|
| Pool Deck | 73' x 28' | 2,044 | 100 |
| 15FiftyFive Lounge & Restaurant | 50' x 30' | 1,500 | 90 |
| Ocean Terrace | 48' x 22' | 1,050 | 60 |
| Catalina Terrace | 76' x 30' | 2,280 | 120 |
| aquaterraspaspa Courtyard | 65' x 54' | 3,510 | 200 |

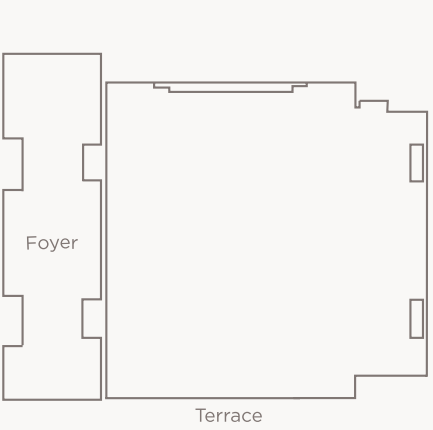

PELICAN

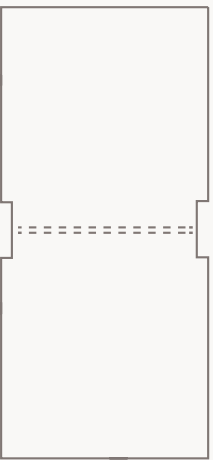

SANDPIPER

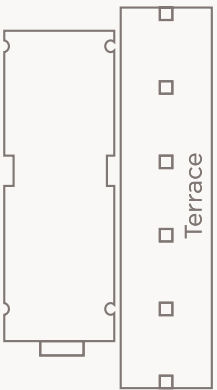

SAND DOLLAR



SAND CASTLE

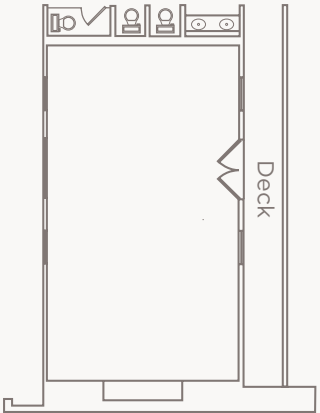

STARFISH



TOP OF THE SURF



SEAGULL /
DOLPHIN
GRAY WHALE /
SEAHORSE



GROUP ACTIVITIES



Go beyond the boardroom with a memorable team-building experience. Our dedicated meetings concierge can help curate the perfect activity itinerary for the whole group to enjoy.

- surfing
- stand up paddle boarding
- fitness on the beach
- mixology classes
- culinary events
- kayaking
- group excursions



SIP & SAVOR



SPLASHES
fresh seaside cuisine

15FIFTYFIVE

With the sea just 25 feet below, you can dine at **Splashes Restaurant** watching the waves roll in - whether you choose to sit inside by an open window or on one of our palm-shaded patios. Executive Chef Ron Fougeray ensures the views are not the only thing to savor, as each dish he prepares is driven by fresh, local & simply delicious ingredients.

If you're looking for something a bit more casual, **Splashes Bar** is the perfect spot for cocktails, light fare & dramatic ocean & sunset views. It is also a great setting for luncheons of up to 40 people.

You can visit **15FiftyFive Lounge** for bites & cocktails around the fire pits. Groups of up to 40 people can brainstorm with the ocean breeze as their inspiration for breakfast, lunch or a noteworthy reception.

Pacific Perk is conveniently located next to the lobby & offers grab & go fare, including breakfast burritos, steaming hot lattes & fresh salads.

AND, OF COURSE, OUR CULINARY TEAM CAN CREATE A DELICIOUS & CUSTOMIZED MENU BASED ON YOUR GROUP'S NEEDS, WHETHER IT'S A BEACHSIDE COFFEE BREAK, SIMPLE LUNCHEON OR AN END OF DAY CELEBRATION.



A LITTLE SPA BY THE SEASHORE

aquaterrasp

Our intimate seaside sanctuary celebrates Surf & Sand Resort's stunning **beachfront locale & dedication to wellness** on all levels. Here, we combine elements of the **sea** (aqua) & **earth** (terra) to create a true **Surf & Sand spa experience**.

Our signature treatments incorporate certified organic ingredients inspired by our natural surroundings as well as science-based products to help you achieve your well-being goals. We also offer special aroma blend treatments, highlighting fresh, seasonal

ingredients. aquaterrasp's experienced estheticians will work with you to customize your treatment and tailor any service to your skin type.

Embrace your senses & pamper yourself in one of our eight spa treatment rooms, hydrospace, steam room or peaceful relaxation areas — both indoors & outdoors. Access to our fitness center, complete with state-of-the-art equipment, is also available. Of course, just steps away, there is always the beach for you to relax, meditate, practice yoga or simply swim in the waves of the Pacific.

EXPLORE & DISCOVER



While Surf & Sand is hard to leave, Laguna Beach has plenty to offer our guests, all within walking distance:

- boutiques & galleries
- acclaimed art festivals
- amazing restaurants
- exciting nightlife
- hiking trails

Other activities close by include:

- championship golf
- South Coast Plaza

Looking for something a little farther afield?

- Dana Point offers abundant opportunities for sailing, sport fishing, jet-skiing and whale watching.
- Mission San Juan Capistrano features 10 acres of gardens, fountains and historic structures.
- The Temecula Valley Wine Region features over 35,000 acres of rolling hills and vineyards plus 30+ wineries open their doors for tours and tastings.

DIRECTION MAP



WALKING MAP



PROPERTY MAP

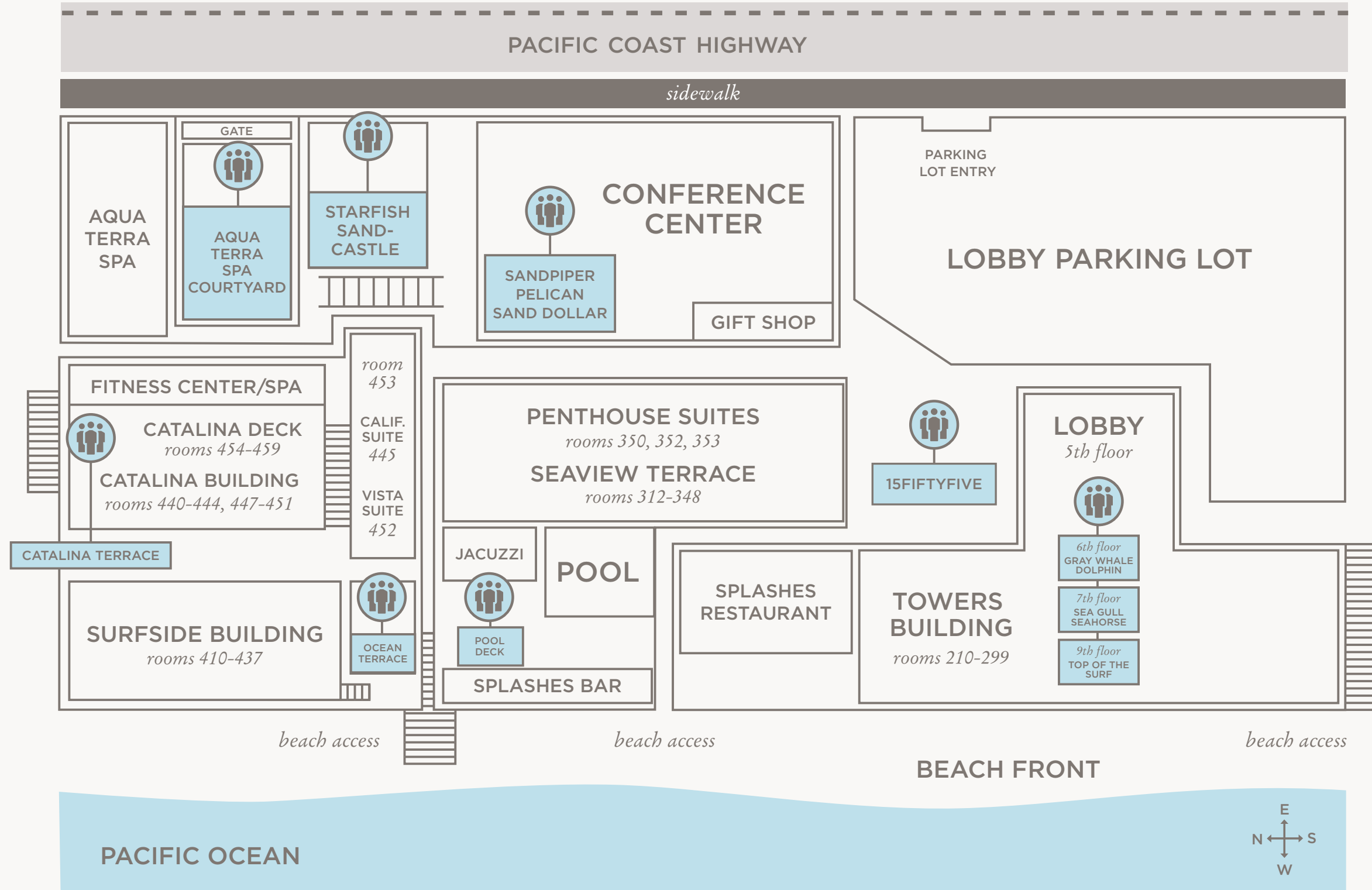

1555 South Coast Highway, Laguna Beach, CA 92651

SURFANDSANDRESORT.COM

844.489.3650



PROPERTY MAP

PACIFIC OCEAN

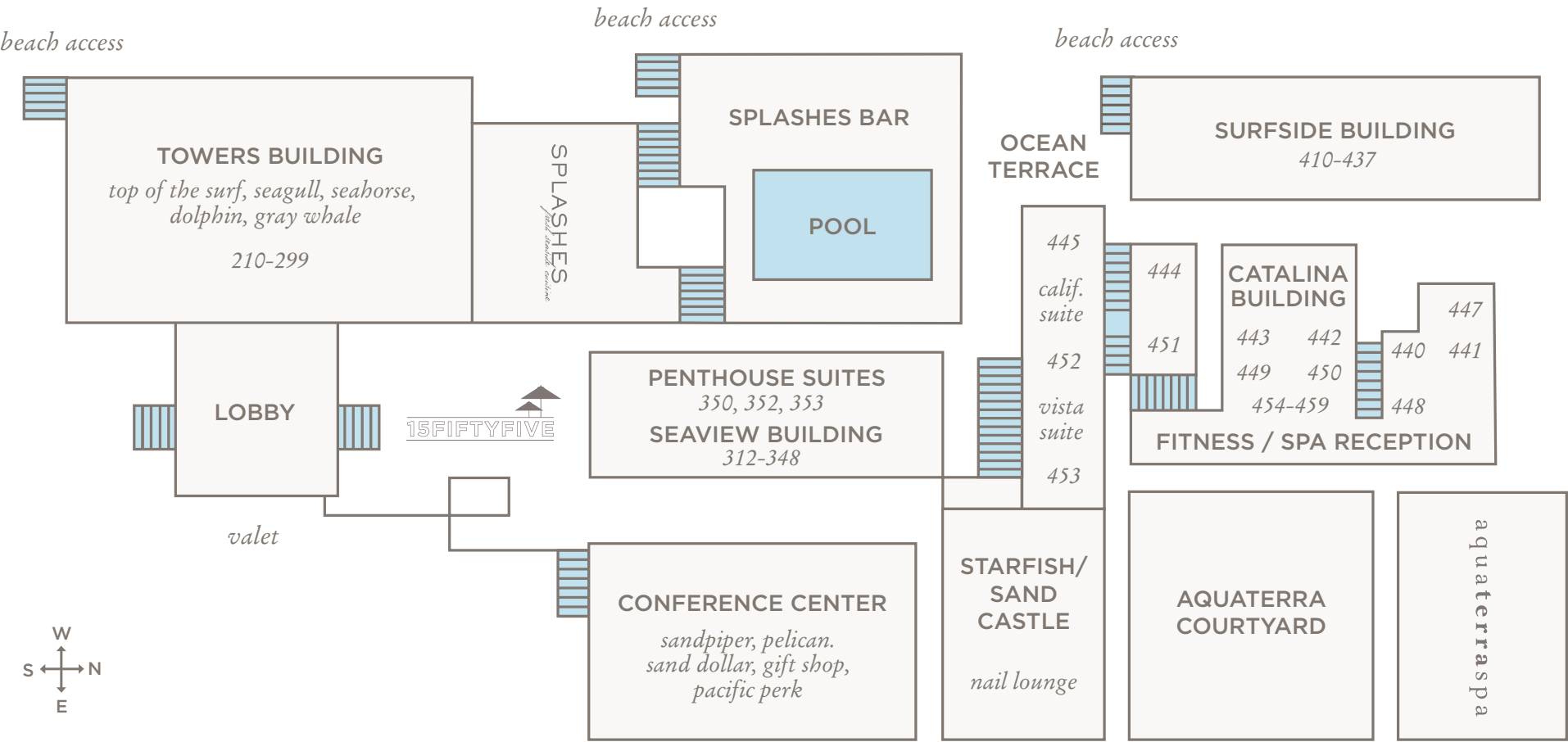

PACIFIC COAST HIGHWAY